

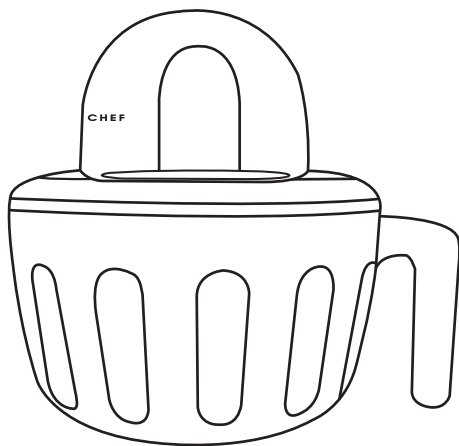

迷你雪糕機
Mini Ice Cream Maker

使用說明書
Instruction Manual



Model No: ICM100001

產品規格及外觀設計如有更改, 恕不另行通知

Product specification and design are subject to
change without prior notice.

安全預防措施

當使用本產品時，請遵循以下的基本的安全指引：

使用前請先閱讀本說明書：

1. 本產品只供家居使用，不可戶外使用。
2. 從插座拔下插頭前，先把本產品轉為“關閉”模式。請勿用拉扯電源線方式來拔下插頭，應抓住插頭並從插座除下，不可直接強行從插座拉下插頭。必須先用手抓緊插頭，之後才從插座拔下。
3. 請勿讓電線接觸熱表面。拆卸和清潔前，必須先讓產品完全冷卻。
4. 不使用本產品時，請務必把電源插頭從電源插座拔出。
5. 請勿用損壞的電源線或產品有任何損壞的情況下操作本產品。為避免觸電，請勿拆卸和重新組裝。如有任何損壞，請親攜到本公司維修部處理。擅自修理/改裝或產品用於非產品原本設計的用途，保修恕不提供。
6. 不可讓兒童單獨使用本產品。
7. 使用中或剛使用後，觸摸熱金屬部件或任何高溫部份可能會被燒傷。
8. 切勿在產品工作時接觸到它的內部。
9. 本產品不能外接定時器或搖控器。
10. 電源線不可懸掛在桌子邊緣或接觸高溫表面，以防損壞電源線。
11. 本產品不可放置於高溫的物體旁邊使用。
12. 請勿將本產品進入水或其他液體中，以避免發生火災、漏電或危害人身安全。
13. 產品在運作時，不可移動。
14. 請勿在無人看管情況下運行本產品。
15. 此產品不適用於身體殘障、感官或精神能力，或缺乏經驗和知識的人操作（包括兒童），除非他們已經接受監督或者指導。
16. 任何時候，都不要沾濕電源線和機身上的連接口；如果電源線接口有水，會導致短路，漏電或其他意外。

特別聲明：

1. 為避免電路負荷過重，請勿在同一電路上操作另一件電器。
2. 使用電壓為DC5V 2A或1A的適配器為產品供電。
3. 請保留此說明書以備將來作參考。
4. 本產品不適合由肢體不健全、感官或精神上有障礙或缺乏相關經驗和知識的人（包括兒童）使用，除非有負責他們安全的人對他們使用本產品進行監督或指導。
5. 照顧好兒童，以確保他們不玩弄本產品。
6. 請勿把本產品、電源線或插頭浸入任何液體中，否則可能導致觸電或火災。如要清潔此產品，請按照說明書上的清潔部份。
7. 當產品無需使用時，請關閉插頭與電源的連接。
8. 請勿用濕手觸摸本產品。
9. 請勿把產品暴露於戶外（雨或陽光底下）。
10. 當插頭插入插座並開啟後，請確保有合資格的人員監督下方可使用本產品。
11. 在使用本產品前，請移除所有包裝物料。
12. 拆開包裝後，檢查是否有損壞，有沒有丟失零件。
13. 所有包裝物料，如塑膠袋、發泡膠、膠帶等都應放在兒童接觸不到的地方，因為此等物料不正常使用會引起兒童窒息，甚至死亡。
14. 只能使用本公司提供在產品和包裝內的配件，否則可能對用戶構成危險，並有可能損壞產品。
15. 使用本產品前，請檢查產品銘牌上標明的電源和電壓是否符合。銘牌貼在產品背面或底部。如有任何疑問，請查詢本公司客戶服務部尋求協助。
16. 請勿讓電源線接觸鋒利的邊緣或熱表面。
17. 本產品不是玩具，不可用在人和動物身上。
18. 本產品不可用在不穩定的地點或燃燒的物體上使用，否則容易引起火災或被燒傷。
19. 零件和配件不包括在保修範圍內，如客人需更換，必須另行跟本公司購買，零件不一定現有，有可能需等待若干時間才能更換。
20. 本產品只限於家居使用，不可作任何商業用途。
21. 如產品須維修，客人必須自行清潔乾淨和殺死所有的昆蟲，否則本公司須收取額外的清潔和滅蟲費用。
22. 請勿拆卸、損壞、刺穿、使本產短路，或將其置於火、火或溫度高於60°的環境中。
23. 應監督兒童，確保他們不會玩弄本產品。
24. 僅在穩定的表面上使用本產品。
25. 請勿將馬達組件浸入水中，請用濕布擦拭並擦乾。
26. 所有配件不適用於洗碗機和消毒器。
27. 請勿在冷凍容器內使用尖銳物體或金屬器具，可使用橡膠刮刀或木勺。
28. 存放於乾燥處或保存在原包裝盒中。
29. 最大運行時間為25分鐘。

產品各部份描述

1	開/開按鈕
2	馬達組件
3	Type-C充電接口
4	透明蓋
5	攪拌槳
6	冷凍杯
7	USB線

注：以上產品圖片僅供參考，具體產品外觀顏色及配置請以實物為準

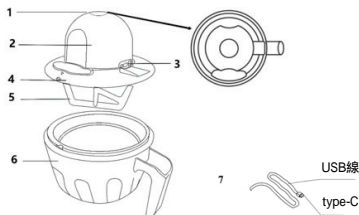

使用本產品：

安裝說明：

- 將攪拌槳安裝到馬達組件上
- 將馬達組件安裝到冷凍杯上。
- (將透明蓋上的「」標記與冷凍杯的卡槽對齊。)

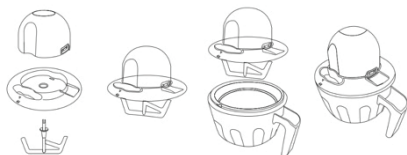

產品操作說明：

1. 首次使用

使用前準備：

- 移除產品內外所有的包裝和運輸材料。
- 首次使用前（或長時間存放後），清洗所有與食物接觸的部件。
- 用濕布擦拭馬達組件。
- 請勿將馬達組件浸入水中。
- 切勿將馬達組件浸入水中或用水沖。
- 冷凍杯、攪拌槳和蓋子可用溫水和溫和洗潔劑清洗。

2. 使用步驟

步驟1

- 將雪櫃冰箱溫度設定為-20 至-22 ；
- 清洗冷凍杯，擦乾後平置放置於冰箱最內側位置，不可倒置或側放；
- 請勿在冷凍杯口部放置其他物件，否則會隔絕冷凍杯與冷空氣，導致冷凍效果不佳；
- 冷凍杯冷凍至少24小時，可長期存放於冰箱中。

步驟2

- 使用一個合適的容器根據食譜準備雪糕原料；
- 將雪櫃溫度設定為5-10℃，將雪糕原料冷藏約1小時。

步驟3

- 選擇涼爽、無風的地點製作雪糕，以減少冷凍杯冷凍能力的散失；
- 開機並檢查攪拌槳是否正正常旋轉；
- 按說明安裝馬達組件、透明蓋和攪拌槳；
- 從雪櫃取出原料和冷凍杯，快速將原料倒入冷凍杯中；
- 將馬達組件放置於冷凍杯上，將透明蓋上的「」標記與冷凍杯的卡槽對齊；
- 開機讓機器運作15分鐘，如有需要可延長至20分鐘。
- 若想要軟質雪糕，15-20分鐘後即可食用。若想要硬質雪糕，將冷凍杯再次放入冰箱冷凍1小時。

參考食譜

1. 芒果雪糕

材料：

- 芒果泥 - 100克
- 細砂糖 - 2湯匙
- 鮮奶油 - 100毫升
- 純牛奶 - 25毫升

製作方法：

- 將芒果切成小塊，用果汁攪拌成芒果泥或醬。
- 將細砂糖、牛奶、鮮奶油和芒果泥充分混合均勻，倒入冷凍杯中，開機讓機器運作15-20分鐘。

2. 哈密瓜奶冰

材料：

- 哈密瓜 - 200克
- 牛奶 - 50毫升

製作方法：

- 將哈密瓜去皮，切成小塊，與牛奶一起放入果汁機中攪拌成果醬或泥狀。
- 將果醬或泥狀物倒入冷凍杯中，開機讓機器運作15-20分鐘。

4. 朱古力雪糕

材料：

- 牛奶 - 50毫升
- 朱古力 - 40克
- 蛋黃 - 1個
- 細砂糖 - 1.5湯匙
- 可可粉 - 5克
- 鮮奶油 - 120毫升

製作方法：

- 將切碎的朱古力與牛奶放入微波爐加熱30秒至融化，攪拌均勻後放涼。
- 將蛋黃和細砂糖攪打至泛白，加入牛奶並混合均勻，倒入鍋中，用小火加熱至沸騰（需不斷攪拌），然後靜置完全冷卻。
- 將上述混合食材與可可粉和鮮奶油倒入冷凍杯中，開機讓機器運作15-20分鐘。

3. 士多啤梨乳酪雪糕

材料：

- 熟蛋黃 - 1個
- 細砂糖 - 1.5湯匙
- 無糖原味乳酪 - 45毫升
- 鮮奶油 - 135毫升
- 士多啤梨泥 - 1湯匙

製作方法：

- 將士多啤梨切成小塊，用果汁攪拌成士多啤梨泥或醬。
- 將熟蛋黃壓碎，加入細砂糖並充分混合。
- 再倒入無糖乳酪和鮮奶油，再次攪拌均勻後靜置備用。
- 將上述混合食材和士多啤梨泥倒入冷凍杯中，開機讓機器運作15-20分鐘。



清潔及保養

- 清潔前，必須先拔掉電源插頭及充電線。
- 冷凍杯、攪拌槳和蓋子可用溫水和溫和洗潔劑清洗。
- 請勿將馬達組件和冷凍杯放入洗碗機。馬達組件可用濕布擦拭。
- 切勿將馬達組件浸入水中或用水沖洗。
- 從馬達組件上取下蓋子後再清洗蓋子，請勿在蓋子與馬達組件安裝在一起時沖洗蓋子。
- 確保所有部件完全乾燥後再將產品存入包裝盒。
- 切勿將潮濕的冷凍杯放入冰箱。
- 切勿將攪拌槳存放在冰箱中。

故障排除

雪糕製作失敗的原因

冷凍杯未充分冷凍或冷凍不佳：

- 務必確保雪糕冰箱溫度設定為最冷！確保冰箱內溫度為 -20°C 或以下（ -22°C ）；對於機械溫控開關的冰箱，設定為最低冷凍設定。
- 使用前，確保冷凍杯已冷凍24小時以上，且雪糕原料已冷藏1小時。
- 確保冷凍杯在冰箱中未倒置或側放：
- 將冷凍杯放置於冰箱最內側位置，以減少頻繁開關冰箱的影響。
- 冷凍杯充分冷凍的標準：冷凍杯外壁應有白色霜層（如圖所示），若白色霜層完全變成水滴，則表示冷凍杯未充分冷凍。
- 下次使用時，應調整雪糕冰箱溫度更低（以增強冷凍效果）。

食譜或原料問題：

- 嚴格遵循品牌推薦的雪糕食譜，因為雪糕對原料的水分和脂肪含量有嚴格要求。
- 確保總原料量小於250克。
- 確保原料未過期。



技術參數

型號	電壓	功率
ICM100001	DC 5V, 2.0A	6W

小家電產品保修條款

敬啟者有限公司（“本公司”）提供一年保修服務（由有效商戶發票上的購買日期起計算），保修期以後，客戶須按照維修部的修理報價支付一切費用。

(一) 客戶應按照產品使用說明書之指引使用產品，本公司對於任何因產品不適當使用或任何產品之故障，損壞或停頓而引致任何人士或財產上直接間接損失及破壞概不負責。

(二) 客戶不可擅自篡改產品型號，機身編號或商戶發票內容。如發現者本公司將不向客戶提供保修服務。

(三) 由於人為損壞、錯誤使用，疏忽，擅自修理/改裝或產品用於非產品原本設計之用途，保修服務恕不提供。

(四) 本公司提供之保修服務不包括產品表面、機身、損耗性零件及配件。

(五) 客戶需自行將產品送往本公司之維修部，並於修妥後，於同一地點取回。經更換後之任何損壞零件，將歸本公司所有。

(六) 所有交到維修部之物品，在本公司發出通知取回後30天內仍不領回，本公司將有權作出處理，由此所引致之任何損失，本公司概不負責。

(七) 保修條款如有任何更改，恕不另行通知。如有任何爭議，本公司保留最終決定權。

Important Safety Instructions

**When using this appliance, basic precautions should always be followed, including the following:
Read all instructions before use.**

1. This product is only for home use, not for outdoor.
2. Remove the product from the outlet to the "off" mode before unplugging the plug from the outlet. Do not use the way to pull the power cord to unplug the plug, should be hold the plug and remove it from the socket. Do not pull down the plug directly from the socket by pressing the rewinding system directly. Remove the plug from the socket by hand and then retract the wire.
3. Do not allow the wires to touch the hot surface. Before removing and cleaning, the product must be completely cooled.
4. When not in use, be sure to unplug the power plug from the power outlet.
5. Do not operate this product with any damage to the power cord. In order to avoid electric shock, do not disassemble and reassemble. If any damage, please carry it to our maintenance center. Unauthorized repair / modification or product for non-product design purposes, warranty will not provide.
6. Do not allow children to use this product separately.
7. Touch hot metal parts or steam may burn.
8. Do not touch the inside of the product while it is working.
9. This product cannot be connected to an external timer or remote control.
10. The power cord should not be hung over the edge of the table or come into contact with hot surfaces to prevent damage to the power cord.
11. This product cannot be used near high-temperature objects.
12. Do not put this product into water or other liquids to avoid fire, electric leakage or personal safety hazard.
13. The product cannot be moved while it is in operation.
14. Do not operate this product unattended.
15. This product is not intended to be operated by persons (including children) with physical disabilities, sensory or mental capabilities, or lack of experience and knowledge, unless they have received supervision or instruction.
16. Do not get the power cord and the connection port on the machine wet at any time; if there is water in the power cord port, it may cause short circuit, leakage or other accidents.

Special statement:

1. To avoid overloading the circuit, do not operate the other on the same circuit.
2. Use an adapter with voltage DC5V 2A or 1A to power the product.
3. Please keep this manual for future reference.
4. This appliance is not intended for use by persons (including children) with reduced physical, sensory or mental capabilities, or lack of experience and knowledge, unless they have been given supervision or instruction concerning use of the appliance by a person responsible for their safety.
5. Children should be supervised to ensure that they do not play with the appliance.
6. Do not immerse the product, power cord, or plug in any liquid. Doing so may cause electric shock or fire. To clean the product, follow the Clean & Maintenance section on the instructions.
7. When the product is not in use, disconnect the plug from the power supply.
8. Do not touch the product with wet hands.
9. Do not expose the product to outdoor (rain or under the sun).
10. After inserting the plug into the socket and opening it, make sure that the qualified personnel supervise the use of the product.
11. Before using this product, remove all packaging materials.
12. After unpacking, check for damage and there are no missing parts.
13. All packaging materials, such as plastic bags, polyfoam, tape, etc. should be placed in places where children are not exposed, because improper use of these materials will lead to child suffocation, and even death.
14. Use only the parts provided in the product and in the packaging, otherwise it may pose a hazard to the user and may damage the product.
15. Before using the product, please check the product rating label on the power, voltage is consistent. The rating labels attached to the back of the product. If you have any questions, please contact our customer service department for assistance.
16. Do not allow the power cord to touch a sharp edge or hot surface, during operation.
17. This product is not a toy, cannot be used directly into the people and animals.
18. This product cannot be used in unstable locations or burning objects, otherwise it is likely to cause a fire or burn.
19. **Parts are not included in the warranty**, if you need to be replaced, must be purchased with my company. Parts are not necessarily available; it may take some time to replace.
20. This product is for home use only, not for any commercial purposes.
21. **If the product needs to be repaired, client must clean the product and kill all the insects before sent to our repair centre**, otherwise our company will charge extra cost for cleaning and pest control.
22. Do not disassemble, squeeze, puncture, short-circuit this product or put it into water, fire or in an environment with a temperature higher than 60°C
23. Children should be supervised to ensure that they do not play with the appliance.
24. Only use this appliance on a stable surface.
25. Do not immerse motor in water. Please wipe with a damp cloth and dry it.
26. All accessories are not suitable for dishwashers and sterilizers.
27. Do not use sharp objects or utensils inside the cooling containers. A rubber spatula or wooden spoon may be used.
28. Store in a dry place or keep in the box.
29. The maximum operation time is 25 minutes.

Parts

1	ON/OFF switch
2	Motor unit
3	Type-C charging port
4	Transparent lid
5	Paddle
6	Freezing cup
7	USB cable

Note: The above product pictures are for reference only. The specific product appearance, color and configuration shall prevail.

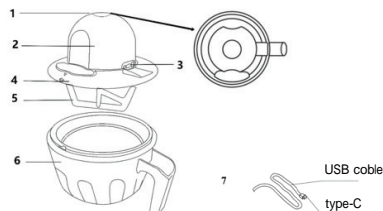

How to use

Operating Instructions:

Installation instruction:

- Fit the paddle into the motor unit;
- Attach motor to freezing cup. (Align the "▼" mark on the transparent lid and the slot of freezing cup.)

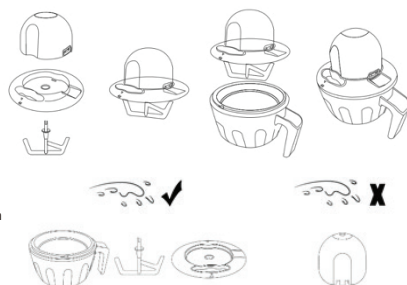

1. First Use

- Before first use, remove all package and transport materials from the inside and outside of the appliance.**
- Before using for the first time (or after prolonged storage time), wash any parts that will come into contact with food.
- Wipe the motor unit with damp cloth.
- Do not immerse motor unit into water.
- Never immerse the motor unit into water or rinse it with water.
- The freezing cup, paddle and lid can be cleaned with warm water and mild detergent.

How to use:

Step1:

- Set the freezer temperature to -20°C to -22°C;
- Wash the freezing cup, wipe them dry and place them squarely in the innermost position of the freezer, not upside down or sideways;
- Do not cover the mouth of the freezing cups with obstacles, otherwise it will isolate the freezing cups from the cold, resulting in poor freezing;
- Freezing cups need to be frozen for at least 24 hours and can be kept in the freezer for a long period of time.

Step2:

- Using 1 suitable container to prepare ice cream ingredients according to the recipe and
- Set the temperature of the refrigerator freezer to 5°C and chill the ice cream ingredient for about 1 hours.

Step3:

- Choose a cool, windless location to make it to minimize the dispersion of the freezing power of the freezing cup;
- Switch on and check if the paddle rotates normally. Install motor transparent lid and paddle as instructed.
- Take the mixture and the freezing cup out from the freezer, quickly pour the mixture into freezing cup.
- Place the motor unit on the freezing cup, align "▼" mark on the transparent lid with the catch of the freezing cup;
- Switch on and let the machine work for 15 minutes, if necessary, let the machine work until 20 minutes.
- If you want soft ice cream, the ice cream is ready to serve after 15-20 minutes. For hard ice cream, place the cup into the freezer compartment again for 1 hours.

Step 1



Freeze at least 24 hours

Step 2

230-250 ml

5°C

Chill ingredient mixture for 1 hour

Freeze at least 24 hours

-20°C

Step 3



Recipe Reference

1. Mango Ice Cream

Ingredients:

- Mango puree - 100g
- Granulated sugar - 2 tbsp
- Whipped cream - 100ml
- Pure milk - 25ml

How to make

- Cut the mango into pieces and blend into mango puree or sauce.
- Blend the granulated sugar, milk, cream and mango puree well, pour into the cooling cup, switch on, let the machine work for 15-20 minutes.

4. Chocolate Ice Cream

Ingredients:

- Milk - 50ml
- Chocolate - 40g
- Egg yolk - 1pc
- Granulated sugar - 1.5 tbsp
- Cocoa powder - 5g
- Whipped cream - 120ml

2. Cantaloupe Juice Milk Ice

Ingredients:

- Cantaloupe - 200g
- Milk - 50ml

How to make

- Peel the cantaloupe, cut it into small pieces and add the milk to the juicer to make a jam or puree.
- Put the jam or puree into the cooling bowl, switch on, let the machine work for 15-20 minutes.

How to make

- Heat the chopped chocolate and milk in the microwave for 30 seconds to melt, stir well and let it cool.
- Stir and whisk the egg yolks and granulated sugar until white, add the milk and mix well, pour into a saucepan, heat over low heat until it comes to a boil (stirring constantly) and set aside to cool down completely.
- Put above ingredient puree into the freezing cup, switch on, let the machine work for 15-20 minutes.

3. Strawberry Yogurt Ice Cream

Ingredients:

- Cooked egg yolk - 1pc
- Granulated sugar - 1.5 tbsp
- Plain unsweetened yogurt - 45ml
- Whipping cream - 135ml
- Strawberry puree - 1 tbsp

How to make

- Cut the strawberries into pieces and blend into strawberry puree or sauce.
- Crush the cooked egg yolk, add granulated sugar and mix well. Pour in the unsweetened yogurt and whipped cream, mix well again and set aside.
- 3 Pour the above mixture and strawberry puree into the cooling cup and switch on, let the machine work for 15-20 minutes.

Cleaning and Maintenance

Before cleaning, be sure to unplug the power cord and charging cable

- The freezing cup, paddle and lid can be cleaned with warm water and mild detergent.
- Do not put motor unit and freezing cup in the dishwasher. The motor unit can be cleaned by using damp cloth.
- Never immerse the motor unit in water and never rinse it with water.
- Always wash lid after removing it from motor unit. Do not rinse the lid when it installed motor unit together.
- Make sure all parts are dried thoroughly before store item into box
- Never place freezing cup in freezer if it is still wet
- Never store the paddle in the freezer.

Trouble Shooting

Reasons Why Ice Cream Making is failed

Freezing cup is not well or insufficiently frozen:

- Always make sure that the refrigerator freezer temperature is set to the coldest setting. Make sure that the temperature inside the freezer is -20°C and below (-22°C); For refrigerators with mechanical temperature control switches, set to the lowest freezer setting.
- Before using, always make sure the freezing cup has been frozen for 24 hours or more, and the ice cream mixture has been chilled for 1 hour.
- Always make sure the freezing cup is not stored upside down or sideways in the freezer;
- Always place the freezing cup in the innermost position of the freezer, to reduce the impact of the freezer being open frequently.

Freezing cup well-frozen standard:

- there should still be white frost on the outer wall of the freezing cup (as shown below) if the white frost has been completely turned into water droplets, which indicates that the freezing cup is not well frozen.
- In next use, the freezer should be adjusted to lower the temperature (to enhance the freezing effect).

Recipes or material problems:

- Strictly follow the brand's recommended recipes for ice cream, as ice cream has strict requirements on the moisture and fat content of the ingredients.
- Make sure the total material amount is less than 250g
- Make sure the ingredients are not out of date



Technical Specification

Model	Voltage	Power
ICM100001	DC 5V, 2.0A	6W

SMALL HOME APPLIANCES WARRANTY TERMS & CONDITIONS

MAIN PLAN LIMITED (hereinafter called "the Company") offers one year warranty service to the product (commencing from the date of purchase invoice by the authorized dealers). Services beyond the said warranty period will be charged according to the quotation from our Service Department.

1. Customer should follow the operating instruction in operating the product. The Company shall not be liable for any direct or indirect loss or damage to any person or property, howsoever caused arising from improper use, or any stoppage, breakdown or failure of the product.
2. The warranty service will not be offered if the model, serial number of the product or the invoice of the authorized dealers has been altered or effaced.
3. This warranty does not cover any damage or loss caused by man-made, misuse, neglect, unauthorized repair / modification or use of the product for any purpose other than the original designed.
4. This warranty service does not include any surface, cabinet, consumptive parts and accessories.
5. Customer should be responsible to carry the product to our Service Department for rendering of service and collect back the product at the same location after repaired. Any defective part which has been replaced should become the property of the Company.
6. All articles left unclaimed by the customer within 30 days after notification will be disposed of at our own discretion and the Company shall not be liable or responsible to the customer for such articles or for any loss or damage whatsoever in such event.
7. All terms stated are subject to change without notice. In case of dispute, the Company reserves the right for final judgment and decision.

客戶服務中心：

Customer Service Centre :

查詢電話：(852) 2698 9280

Telephone :

地址：香港新界荃灣白田壩街23-29號長豐工業大廈東翼3樓

Address : 3/F, Cheung Fung Industrial Building East Wing, 23-29
Pak Tin Par Street, Tsuen Wan, N.T., Hong Kong

辦公時間 Office Hour :

星期一至五 Monday to Friday : 09:00 – 12:30 ; 14:00 – 17:30

星期六、日及公眾假期休息

Saturday, Sunday and public holiday closed