



客戶服務中心：查詢電話：(852) 2698 9280  
Customer Service Centre : Telephone :

地址：香港新界荃灣白田壩街23-29號長豐工業大廈東翼3樓  
Address : 3/F, Cheung Fung Industrial Building East Wing, 23-29  
Pak Tin Par Street, Tsuen Wan, N.T., Hong Kong

辦公時間 Office Hour :  
星期一至五 Monday to Friday : 09:00 – 12:30 ; 14:00 – 17:30  
星期六、日及公眾假期休息  
Saturday, Sunday and public holiday closed



## 迷你玻璃食物料理機 USB Charging Mini Glass Food Chopper

使用說明書  
Operating Instruction



Model No : ISB502003PL

產品規格及外觀設計如有更改, 恕不另行通知  
Product specification and design are subject to  
change without prior notice.

### 安全預防措施

當使用本產品時，請遵循以下的基本的安全指引：

使用前請先閱讀本說明書：

1. 本產品只供家居使用，不可戶外使用。
2. 從插座拔下插頭前，先把本產品轉為“關閉”模式。請勿用拉扯電源線方式來拔下插頭，應抓住插頭並從插座除下，不可直接強行從插座拉下插頭。必須先用手抓緊插頭，之後才從插座拔下。
3. 請勿讓電線接觸熱表面。拆卸和清潔前，必須先讓產品完全冷卻。
4. 不使用本產品時，請務必把電源插頭從電源插座拔出。
5. 請勿用損壞的電源線或產品有任何損壞的情況下操作本產品。為避免觸電，請勿拆卸和重新組裝。如有任何損壞，請親攜到本公司維修部處理。擅自修理/改裝或產品用於非產品原本設計的用途，保修恕不提供。
6. 不可讓兒童單獨使用本產品。
7. 使用中或剛使用後，觸摸熱金屬部件或任何高溫部份可能會被燒傷。
8. 切勿在產品工作時接觸到它的內部。
9. 本產品不能外接定時器或搖控器。
10. 首次使用本產品時，可能會產生輕微的異味或白煙，只要把本產品放在通風處，異味和白煙很快便會消散。

### 特別聲明：

1. 為避免電路負荷過重，請勿在同一電路上操作另一件電器。
2. 如果延長線有必要使用，應使用13安培的電線。額定電流比此產品較小的電線可能引起過熱及短路。
3. 請保留此說明書以備將來作參考。
4. 不要讓兒童或未經培訓的人員在不經監督的情況下使用本產品。
5. 不要將本產品，電源線或插頭浸入任何液體中。否則可能導致觸電或火災。如要清潔此產品，請按照說明書上的清潔部份。
6. 當產品無需使用時，請斷開插頭與電源的連接。
7. 請勿用濕手觸摸本產品。
8. 請勿將產品暴露在戶外（雨或陽光底下）。
9. 當插頭插入插座並開啟後，請確保有合資格的人員監督下方可使用本產品。
10. 在使用本產品前，請移除所有包裝物料。
11. 拆開包裝後，檢查是否有損壞，有沒有丟失零件。
12. 所有包裝物料，如塑料袋，發泡膠，膠帶等.. 都應放在兒童接觸不到的地方，因為此等物料不正當使用會引至兒童窒息，甚至死亡。
13. 只能使用本司提供在產品及包裝內的配件，否則可能對用戶構成危險，並有可能損壞產品。

### 特別聲明：

14. 在使用產品前，請檢查產品銘牌上標明的電源，電壓是否符合。銘牌貼在產品背面。  
如有任何疑問，請查詢我司客戶服務部尋求協助。
15. 請勿讓電源線接觸鋒利的邊緣或熱表面。
16. 本產品不是玩具，不可用在人及動物身上，否則會被燙傷。
17. 本產品不可用在不穩定的地點或燃燒的物體上使用，否則容易引起火災或被燒傷。
18. 零件及配件不包括在保修範圍內，如客人需更換，必須另行跟我司購買。零件不一定現有，有可能需等待若干時間才能更換。
19. 本產品只限於家居使用，不可作任何商業用途。
20. 如產品須維修，客人必須自行清潔乾淨及殺死所有之昆蟲。否則我司須收取額外之清潔及滅蟲費用。
21. 第一次使用時，由於該絕緣材料可能有氣味或有煙，這是無害的，很快就會消退。

### 安全注意事項：

**警告：小心鋒利的刀片，避免任何傷害！**

**注意：**

1. 此設備僅供個人或家庭使用。
2. 兒童不可使用該設備。
3. 本設備不適合身體狀況不佳的人使用，缺乏身體、感官或心理能力或缺乏經驗和知識，除非有負責人監督或指導他們使用設備。
4. 不要使設備超載。
5. 本設備不能用於加工硬質食品，如咖啡豆、大豆、明膠、大米、冰塊或冷凍食品。
6. 單次使用不要連續超過30秒。
7. 產品連續工作時間不要超過30秒，超過30秒主機會自動停機。  
連續工作30秒後，需讓主機休息2分鐘後才能使用。  
以工作30秒間隔休息2分鐘為一個周期，  
連續工作3個周期後必須讓產品冷卻30分鐘後再工作，以保證良好的產品壽命。
8. 請勿使用腐蝕性清潔劑進行清洗。
9. 不要直接用水沖洗主機。

充電時，充電線和充電口連接如下圖：



### 產品各部分描述

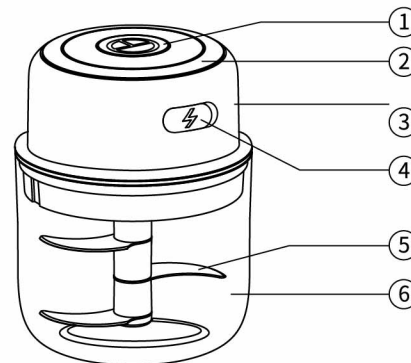

號碼	產品各部份名稱
①	開關按鈕
②	矽膠圈
③	主機
④	USB 充電口
⑤	刀片
⑥	玻璃攪拌杯

### 使用本產品

**使用步驟：**

**第一步**

- ▶ 首次使用前，先插上USB充電線充電，  
充電時紅燈亮起。主機充滿電後，  
指示燈熄滅。然後清洗主機的杯蓋，  
刀片和玻璃攪拌杯。

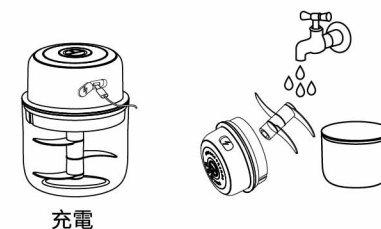

**第二步**

- ▶ 將刀片插入碗內的定心軸上  
(確保刀片安裝到位，可自由旋轉)。  
操作時小心鋒利刀片！然後在攪  
拌杯中加入清洗過的食材  
(低於最大刻度線分量)。

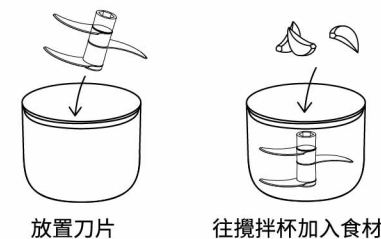

## 使用本產品

### 第三步

- ▶ 食物放入攪拌杯後，沿攪拌杯的兩個槽安裝主機。主機安裝時，藍色指示燈閃爍3次。然後按下開關按鈕，顯示藍色指示燈就開始攪拌加工食物，一鬆開按鈕，機器就停止。不要一次放太多食物，否則刀片可能不會旋轉，此時可以適當取出一些食物後再繼續加工。



### 第四步

- ▶ 開機後，機器在30秒後自動停止工作。如果食物未加工至要求的那麼細膩，可繼續按下開關按鈕進行加工。完成後，取下主機上的攪拌杯，將杯中的食物倒出。接下來，用水沖洗。

## 清潔及保養

1. 使用後立即用清潔布在乾淨的水中(最好是溫水)清洗杯蓋、刀片和攪拌杯。
2. 可以在清水中加入軟性洗滌劑。刀具非常鋒利，請不能用手觸摸。為了避免傷害，用於清洗的水最好應始終保持清澈，以便在清洗過程中可以看到刀具。
3. 用溫暖柔軟的布擦拭主機的外部。切記不可以用水沖洗馬達主機。
4. 清洗完畢後，將所有部件風乾，重新組裝並存放於乾燥處。
5. 本裝置為鋰離子電池供電，產品長時間不使用時請每隔3個月沖一次電，以免電池損壞。

## 技術參數

型 號	充電電壓和電流	額定功率	電池容量
ISB502003PL	DC5V/1A	30W	3.7V 1200mAh

## 故障排除

故障現象	指示燈	產生原因	解決方法
主機安裝後，按下開關而不啟動	<ul style="list-style-type: none"> <li>• 紅藍燈交替閃爍</li> <li>• 紅燈閃爍</li> <li>• 紅燈常亮</li> </ul>	<ul style="list-style-type: none"> <li>• 主機和攪拌杯連接不到位</li> <li>• 電池電量低</li> <li>• 電機損壞或卡住</li> </ul>	<ul style="list-style-type: none"> <li>• 重新連接主機和攪拌杯</li> <li>• 給主機充電</li> <li>• 轉動電機軸，如果還是不行，請聯絡客戶服務中心</li> </ul>
主機不能充電	沒有指示燈	檢查是否充電線鬆脫	插緊充電線或重新換一條充電線
使用中途停機	紅燈閃爍	電池用完	請充電
攪拌刀不能轉動	——	<ul style="list-style-type: none"> <li>• 未安裝妥當刀刃</li> <li>• 刀片被配料纏住或卡住</li> </ul>	<ul style="list-style-type: none"> <li>• 檢查及重新安裝</li> <li>• 拆下主機，取出食材，將食材切成小塊或減少食材，重新啟動</li> </ul>

### 注意：

以上為常見故障分析及排除方法。如遇其他故障請聯繫我們的客戶服務中心。請勿自行拆卸和修理。

### 小家電產品保修條款

敏實有限公司（“本公司”）提供一年保修服務（由有效商戶發票上的購買日期起計算），保修期以後，客戶須按照維修部之修理報價支付一切費用。

- (一) 客戶應按照產品使用說明書之指引使用產品，本公司對於任何因產品不適當使用或任何產品之故障，損壞或停頓而引致任何人士或財產上直接或間接損失及破壞概不負責。
- (二) 客戶不可擅自刪改產品型號，機身編號或商戶發票內容。如發現者本公司將不向客戶提供保修服務。
- (三) 由於人為損壞、錯誤使用，疏忽，擅自修理 / 改裝或產品用於非產品原本設計之用途，保修服務恕不提供。
- (四) 本公司提供之保修服務不包括產品表面、機身、損耗性零件及配件。
- (五) 客戶需自行將產品送往本公司之維修部，並於修妥後，於同一地點取回。經更換後之任何損壞零件，將歸本公司所有。
- (六) 所有交到維修部之物品，在本公司發出通知取回後30天內仍不領回，本公司將有權作出處理，由此所引致之任何損失，本公司概不負責。
- (七) 保修條款如有任何更改，恕不另行通知。如有任何爭議，本公司保留最終決定權。

### IMPORTANT SAFETY INSTRUCTIONS

When using this appliance, basic precautions should always be followed, including the following:

**Read all instructions before use.**

1. This product is only for home use, not for outdoor.
2. Remove the product from the outlet to the "off" mode before unplugging the plug from the outlet. Do not use the way to pull the power cord to unplug the plug, should be hold the plug and remove it from the socket. Do not pull down the plug directly from the socket by pressing the rewinding system directly. Remove the plug from the socket by hand and then retract the wire.
3. Do not allow the wires to touch the hot surface. Before removing and cleaning, the product must be completely cooled.
4. When not in use, be sure to unplug the power plug from the power outlet.
5. Do not operate this product with any damage to the power cord. In order to avoid electric shock, do not disassemble and reassemble. If any damage, please carry it to our maintenance center. Unauthorized repair / modification or product for non-product design purposes, warranty will not provide.
6. Do not allow children to use this product separately.
7. Touch hot metal parts or steam may burn.
8. Do not touch the inside of the product while it is working.
9. This product cannot be connected to a external timer or remote control.
10. When first time to use this appliance, a slightly smell and white smoke may be emitted. It is normal status. Please ensure sufficient ventilation, those smell and white smoke will disappear quickly.

### SAFETY INSTRUCTION

1. To avoid overloading the circuit, do not operate the other on the same circuit.
2. If the extension cord is necessary, use a 13 amp cable. A smaller current than this product may cause overheating and short circuit.
3. Please keep this manual for future reference.
4. Do not allow children or untrained personnel to use the product without supervision.
5. Do not immerse the product, power cord, or plug in any liquid. Doing so may cause electric shock or fire. To clean the product, follow the cleaning section on the instructions.
6. When the product is not in use, disconnect the plug from the power supply.
7. Do not touch the product with wet hands.
8. Do not expose the product to outdoor (rain or under the sun).
9. After inserting the plug into the socket and opening it, make sure that the qualified personnel supervise the use of the product.
10. Before using this product, remove all packaging materials.
11. After unpacking, check for damage and there are no missing parts.
12. All packaging materials, such as plastic bags, polyfoam, tape, etc. should be placed in places where children are not exposed, because improper use of these materials will lead to child suffocation, and even death.
13. Use only the parts provided in the product and in the packaging, otherwise it may pose a hazard to the user and may damage the product.

## SAFETY INSTRUCTION

- Before using the product, please check the product rating label on the power, voltage is consistent. The rating labels attached to the back of the product. If you have any questions, please contact our customer service department for assistance.
- Do not allow the power cord to touch a sharp edge or hot surface. during operation.
- This product is not a toy, cannot be used directly into the people and animals, otherwise it will be burned.
- This product cannot be used in unstable locations or burning objects, otherwise it is likely to cause a fire or burn.
- Parts are not included in the warranty, if you need to be replaced, must be purchased with my company. Parts are not necessarily available; it may take some time to replace.
- This product is for home use only, not for any commercial purposes.
- If the product needs to be repaired, client must clean the product and kill all the insects before sent to our repair center, otherwise our company will charge extra cost for cleaning and pest control.
- You may notice an odor & gas using the appliance for the first time, due to the insulation material. This is harmless and will subside quickly.

## SAFETY PRECAUTIONS

### Attention:

- This appliance is for personal or household use ONLY.
- Children being supervised NOT to pay with the appliance.
- Children should not use the device. This device is not intended for use by persons with medical conditions, lacking physical, sensory or mental capabilities or lack of experience and knowledge, unless they are supervised or instructed to use the device.
- DONOT overload the appliance.
- This appliance can NOT be used to process hard food, such as coffee beans, soybeans, gelatin, rice, ice cubes or frozen food.
- DO NOT operate CONTINUOUSLY for more than 30 seconds for each time.
- The continuous working time of the product should not exceed 30 seconds, and the main unit will automatically shut down if it exceeds 30 seconds.  
After working continuously for 30 seconds, it needs to rest for 2 minutes before use again.  
A cycle of 30 seconds of work and 2 minutes of rest is a cycle. After 3 cycles of continuous work, the machine is needed to cool for 30 minutes before working to ensure product life.
- DO NOT use abrasive or corrosive cleaning agents for cleaning.
- DO NOT rinse the main unit directly with water.

When charging, the charging cable and the charging port are connected as following:



## PARTS

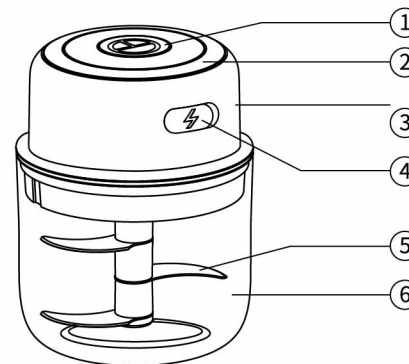

Number	Part name
①	Press for switch on
②	Non-slip silicone
③	Main engine
④	USB charging port
⑤	Blades
⑥	Glass blending jar

## HOW TO USE

### Using steps:

#### Step one

- For the first use, please fully charge the main engine. After the main engine is fully charged, the indicator light will be off. Then clean the lid of main engine, blades and blender jar.



Charging



#### Step two

- Insert the blades into the shaft of the blender jar, and then fill the blender jar with washed ingredients (up to the maximum food limit).

Beware of sharp blades!



Place the blades



Fill the blender jar with ingredients

## HOW TO USE

### Step three

- After the food is put into the blender jar, install the main engine along the two slots of the jar. When the main engine is installed, the blue indicator light flashes 3 times. Then press the switch to process the food, and the blue light is on. Once the switch button is released, the machine will stop. Do not over load the jar, otherwise the blades may not rotate when it starts. Please take out some food properly and continue the processing.

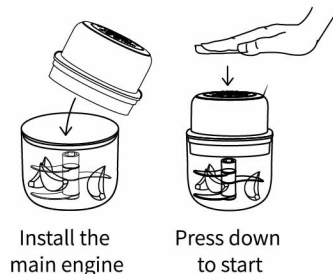

### Step four

- After starting, it will automatically stop working after 30 seconds. If the food is not so delicate as you expected, continue to press the switch for processing. After finishing, remove the blender jar attached from the main engine and pour out the food in the jar. Next, rinse it with water.

## CLEAN & MAINTENANCE

1. Clean the splash guard, blades and blending jar in clean water (better to be warm) with a cleaning pad, immediately after use.
2. Soft detergent can be added into cleaning water. The cutter is very sharp and must NOT be touched by hands. To avoid injuries, the cleaning water shall ALWAYS be noticeably clear, so that the cutter can be seen during the cleaning process.
3. Use a soft warm cloth to wipe and clean the outside of the main unit.
4. After cleaning, dry out all the parts, reassemble and store the appliance in a dry place.
5. The appliance is Li-Lon battery operated and it must be maintained/Charged after every 3 months of none-use.

## TECHNICAL SPECIFICATION

Model	Charging voltage and current	Power	Lithium battery capacity
ISB502003PL	DC5V/1A	30W	3.7V 1200mAh

## TROUBLE SHOOTING

Fault situation	Indicator light	Reason	Solution
After the main engine is installed, the machine does not work after pressing the switch	<ul style="list-style-type: none"> <li>• The red and blue lights flash alternatively</li> <li>• The red light is flashing</li> <li>• The red light is always on</li> </ul>	<ul style="list-style-type: none"> <li>• The main engine and the blender jar are not connected perfectly</li> <li>• Battery is low</li> <li>• The motor is damaged or stuck</li> </ul>	<ul style="list-style-type: none"> <li>• Reconnect the main engine and the blender jar</li> <li>• Charge the main engine</li> <li>• Turn the motor shaft.</li> </ul> <p>If it still does not work, please contact the customer service for help</p>
The main engine cannot be charged	The light is not working	Check if the charging cable is loose	Plug in the charging cable tightly or replace it with a new one
Stop during processing	The red light is flashing	Run out of battery	Charge the battery immediately
The blades get stuck	—	<ul style="list-style-type: none"> <li>• Not properly installed blade</li> <li>• The blade is entangled or jammed with ingredients</li> </ul>	<ul style="list-style-type: none"> <li>• Check and fix them</li> <li>• Remove the main engine, take out the ingredients and cut the ingredients into small pieces or put less ingredients.</li> </ul>

**Note:** The above are common fault analysis and troubleshooting methods. For other faults, please contact our customer service. Do not disassemble and repair by yourself.

## **SMALL HOME APPLIANCES WARRANTY TERMS & CONDITIONS**

MAIN PLAN LIMITED (hereinafter called "the Company") offers one year warranty service to the product (commencing from the date of purchase invoice by the authorized dealers). Services beyond the said warranty period will be charged according to the quotation from our Service Department.

1. Customer should follow the operating instruction in operating the product. The Company shall not be liable for any direct or indirect loss or damage to any person or property, howsoever caused arising from improper use, or any stoppage, breakdown or failure of the product.
2. The warranty service will not be offered if the model, serial number of the product or the invoice of the authorized dealers has been altered or effaced.
3. This warranty does not cover any damage or loss caused by man-made, misuse, neglect, unauthorized repair / modification or use of the product for any purpose other than the original designed.
4. This warranty service does not include any surface, cabinet, consumptive parts and accessories.
5. Customer should be responsible to carry the product to our Service Department for rendering of service and collect back the product at the same location after repaired. Any defective part which has been replaced should become the property of the Company.
6. All articles left unclaimed by the customer within 30 days after notification will be disposed of at our own discretion and the Company shall not be liable or responsible to the customer for such articles or for any loss or damage whatsoever in such event.
7. All terms stated are subject to change without notice. In case of dispute, the Company reserves the right for final judgment and decision.